

Streetlight “Lens 360°”



Material number: 1500954

Glass: SUPRAX® 8488
Borosilicate Glass

Diameter: 60 mm

Height: 33 mm

Packing unit: 1 pc

Weight: approx. 117g

Operating temperature: up to 450°C

Mechanical properties: radial symmetric flange for rotation,
positioning grooves for mounting

Impact resistance: IK 09

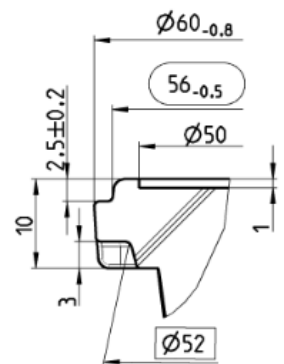

Optics:

Efficiency: 90%

Properties: asymmetric rectangular light distribution

distribution options with more lenses and different lens rotations
and tilt angles (see examples)

LEDs: works best with CREE CXA1850; Others: Bridgelux Vero10-18; V6-18; CREE CXA13XX, CXA15XX, CXA18XX, CXA25XX, CXB1304, CXB15XX, CXB18XX, CXB25XX; OSRAM Soleriq S13, S19, P6, P9; Philips Lumileds Luxeon 120X; Citizen COBs, Edison COBs, Luminus COBs, Nichia COBs

Customs tariff number: 70140000

Light Distributions

